

Legend

- E911 Addresses
- Fire Hydrants
- Gates
- Intersections
- Summits
- City Limits
- ESN Boundaries
- US Hwy
- State Hwy
- County Maintained
- County Not Maintained
- City
- Forest Service
- Driveway
- Streams

1" equals 800'



Map Identifier

1	2	3	4	5	6
7	8	9	10	11	12
13	14	15	16	17	18
19	20	21	22	23	24
25	26	27	28	29	30
31	32	33	34	35	36
37	38	39	40	41	42
43	44	45	46	47	48
49	50	51	52	53	54
55	56	57	58	59	60
61	62	63	64	65	66
67	68	69	70	71	72
73	74	75	76	77	78
79	80	81	82	83	84
85	86	87	88	89	90
91	92	93	94	95	96
97	98	99	100	101	102
103	104	105	106	107	108
109	110	111	112	113	114
115	116	117	118	119	120
121	122	123	124	125	126
127	128	129	130	131	132

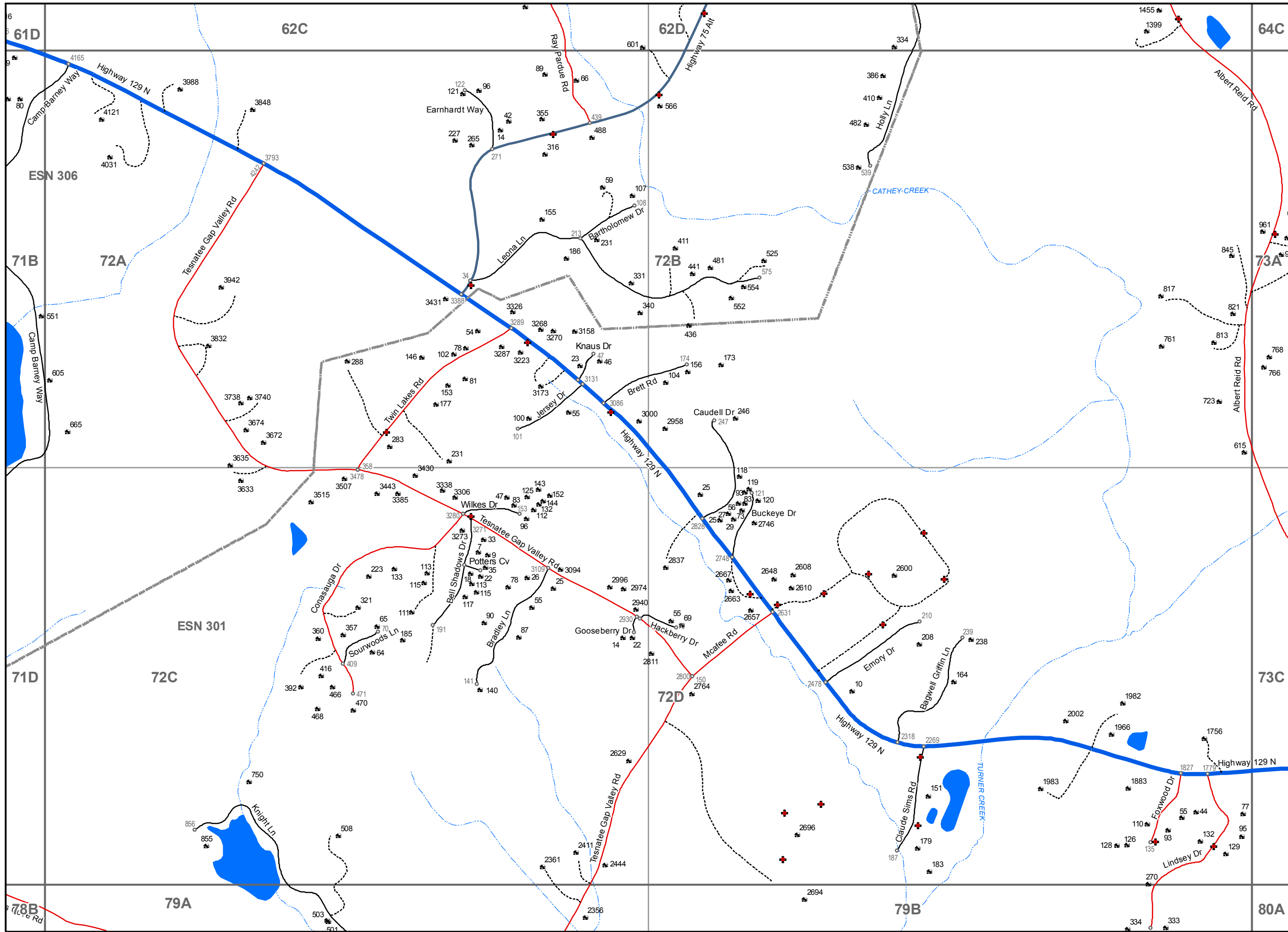

Map showing ESN boundaries and road network. Key roads include Highway 129 N, Tesnatee Gap Valley Rd, Albert Reid Rd, and various local roads like Earnhardt Way, Leona Ln, and Knaus Dr. ESN boundaries are labeled 306, 301, and 72. Geographical features include Cathey Creek, Turner Creek, and Knight Ln. The map is overlaid with a grid of sections labeled 61D, 62C, 62D, 64C, 71B, 72A, 72B, 73A, 71D, 72C, 72D, 73C, 79A, 79B, 79C, 80A, and 78B.